



BL100 INSTALLATION GUIDE

Version: V1.0
Date: 2012.3.16

I. Quick Reference

A. Quick reference for Installation Guide

- II. Check door dimensions and determine desired “door swing”
- III. Install Deadbolt Body
- IV. Install the Front panel Assembly
- V. Install the AA Batteries
- VI. Install the Rear panel Assembly
- VII. Operating Instructions
- VIII. Routine Maintenance

B. List of Lock Accessories

1	Keyhole Cover	6	Screw (4 PCS)
2	Front panel Assembly	7	4 PCS AA Batteries
3	Silica gel backing plate	8	Rear panel assembly
4	Lock body	9	Screw (2PCS)
5	Back Lining Plate	10	Key (2PCS)

II. Check door dimensions and determine desired “door swing”

1. Installation Requirements

The fingerprint deadbolt can be installed on doors of 1.5 – 2 inches (35-50) mm in thickness.

2. Check the direction in which the door is being opened (i.e. right or left-handed swing) and align the deadbolt’s latch-bolt, accordingly.

(1). The deadbolt’s body outside and inside must align properly. Assume you are standing outside the room/structure and facing a door. Basically there are four door opening-directions: Left inward, left outward, right inward and right outward. Left inward/outward means the door swings inward/outward with hinges on the left; right inward/outward means the door swings inward/outward with hinges on the right (see **Figure 1 below**):

(2). Determine the deadbolt’s correct alignment/positioning based on the door’s opening direction (see **Figure 2 below**):

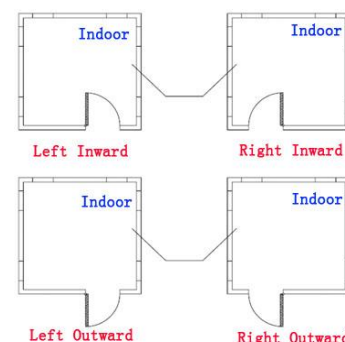

Figure 1

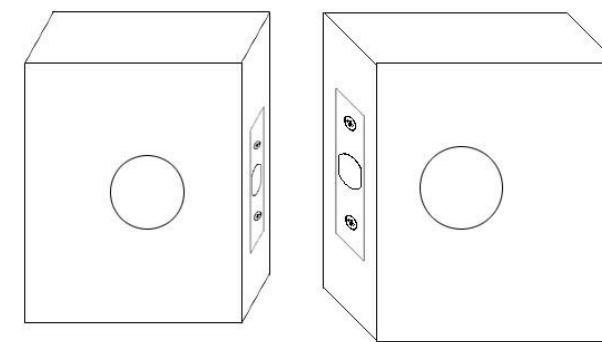

Figure 2

(3). To set the deadbolt as "Left Open" or "Right Open" on the Rear panel Assembly, reference **Figure 3**:

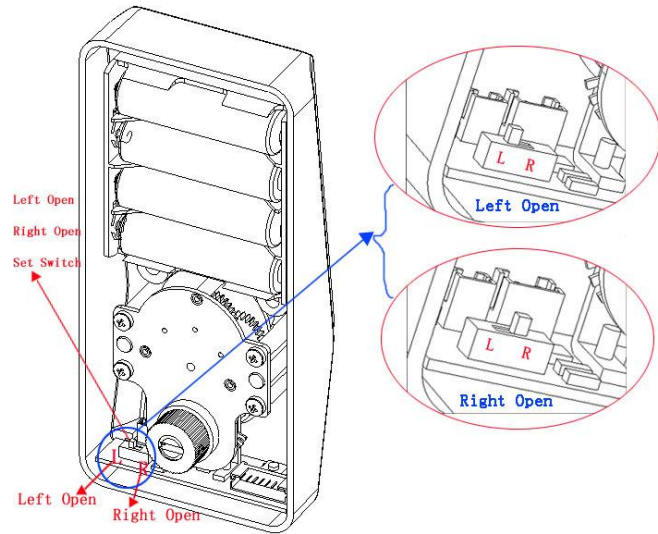

Figure 3

As shown in **Figure 3**, there is a "Left open/Right Open" set switch on the rear panel assembly of the deadbolt. Note the user can turn the switch to the left side (L) to set the door's opening direction as "Left Open"; or turn the switch to the right side (R) to set the door's opening direction as "Right Open".

Note:

- ① Before installing the deadbolt, you must first determine the door's opening direction as either "left open" or "right open".
- ② According to the door's opening direction, switch the "Left/Right Open" set switch to the corresponding position (For "Left Open", position the switch to the left side; For "Right Open" position the switch to the right side).

III. Install Deadbolt Body

1. Determine the desired installation height and position of the deadbolt in relation to the door; then adhere the hole-drilling-template to the door, accordingly (see **Figure 4-1 below**).
2. Insert the deadbolt body into the matching hole slot (see **Figure 5 below**):

 **Note:** There is an "↑UP" symbol on the deadbolt body. Before installing the deadbolt body, make sure its positioning is consistent with the direction of the symbol.

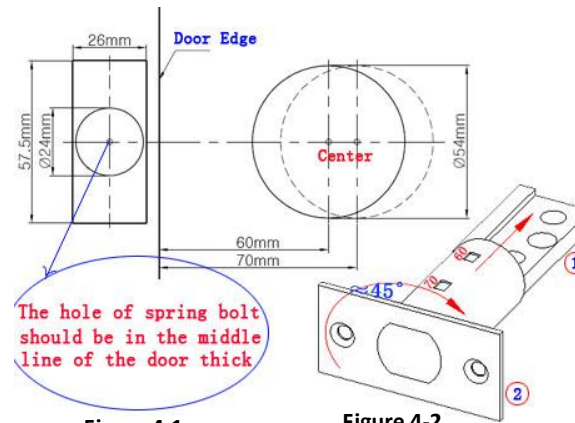

Figure 4-1

Figure 4-2

The hole of spring bolt should be in the middle line of the door thick

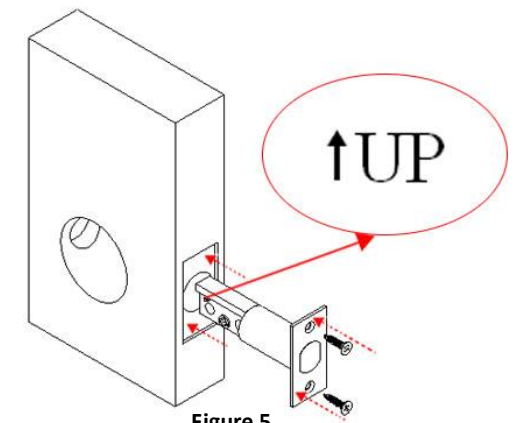



Figure 5

Set the length of the deadbolt body based on the distance from the Door Edge to the center of the circle (the opening hole distance is about 2 ½ inches (65 mm), as shown in **Figure 4-1**). The opening distance matching the default length of the deadbolt body is 2 ¼ inches (60 mm). If the distance of 2 ¾ inches (70 mm) is required, reset the length of the deadbolt body by following these steps:

- (1) **Figure 4-2:** Hold part ① of the Deadbolt Body, rotate part ② by 45°, and pull back part ②.
- (2). Rotate part ② by 45° in the other direction to make the hole on part 2 match with the hole of 2 ¾ inches (70 mm) on the lock body.

 **Note:** When you shorten the length of the Lock Body, perform the following steps:

- (1). Hold part ①, rotate part ② by 45°, and push part ② ahead. (2). Rotate part ② by 45° in the other direction to make the card pillar of the lock body be embedded into the matching card hole of 2 ¼ inches (60 mm).

3. After the procedure is completed, secure the Deadbolt Body using a screwdriver, as shown in **Figure 6**. Insert the screwdriver into the cross-shaped hole of the Deadbolt Body. When you rotate the cylinder clockwise, it springs out automatically, as shown in **Figure 7**. When you rotate the cylinder counterclockwise, it springs back automatically, as shown in **Figure 8**.

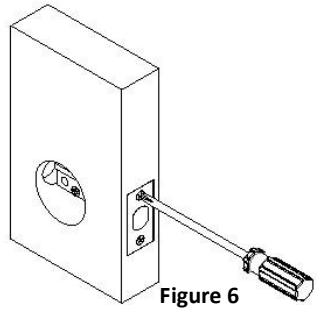

Figure 6

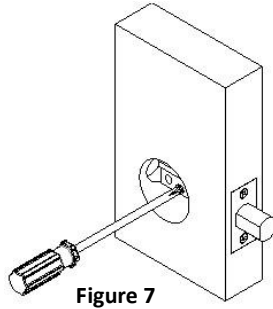

Figure 7

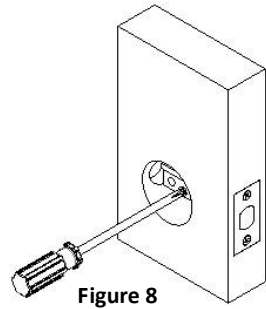

Figure 8

IV. Install the Front panel Assembly

1. Install the Silica gel backing plate on the Front panel Assembly as shown in **Figure 12**.

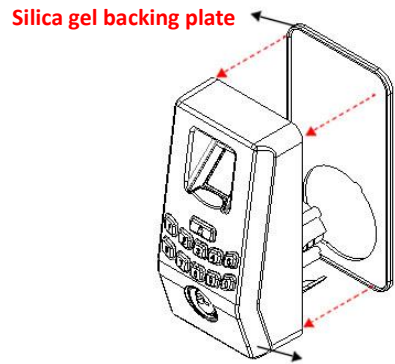

Figure 12

Front panel Assembly

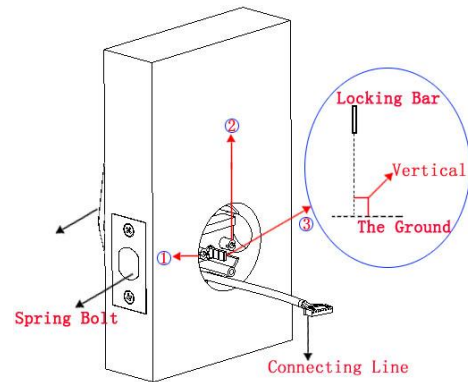

Figure 13

2. Stretch the spring bolt back to the Deadbolt Body and pull the connecting wire out of the hole at the bottom of the deadbolt body.

3. Install the front panel assembly into the matching hole on the door. (There are three holes on the Deadbolt Body, as shown in the preceding figure. The cylinder on the fore plate composition must be pulled out from the cross-shaped hole of the Deadbolt Body and the locking bar must be vertical to the ground.), as shown in **Figure 13**.

4. Install the back lining plate to the mapping hole. Pull the connecting wire out of the oval-shaped hole of the back lining plate (As shown in **Figure 14**), attach the back lining plate and front panel assembly using a screwdriver, as shown in **Figure 15**.

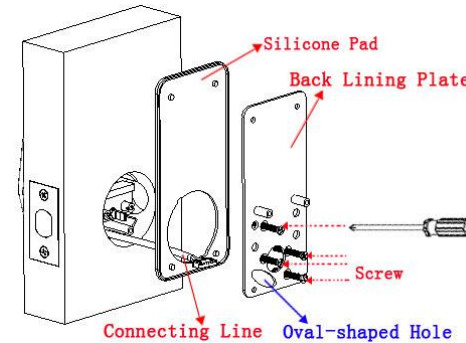

Figure 14

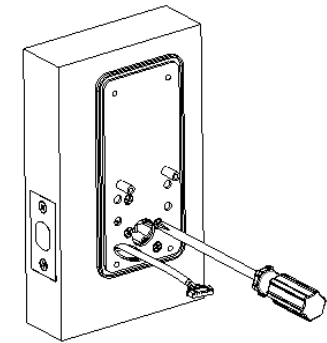

Figure 15

V. Install the AA Batteries

1. Obtain four AA batteries (preferably same brand).
2. Insert the batteries into the Rear panel Assembly properly. As shown in **Figure 16-1** and **16-2**:

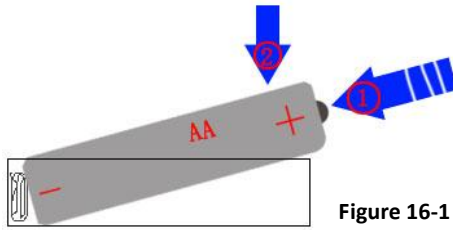

Figure 16-1

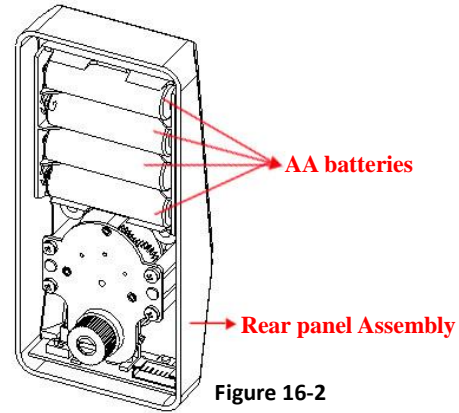

Figure 16-2

VI. Install the Rear panel Assembly

1. Pull the connecting wire into the plug slot of the rear panel assembly as shown in **Figure 17**:

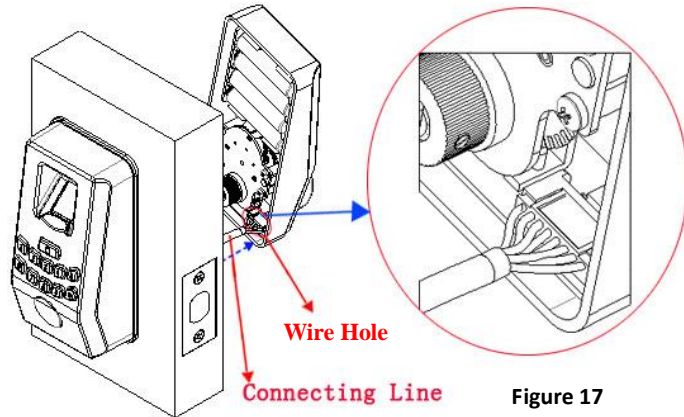

Figure 17

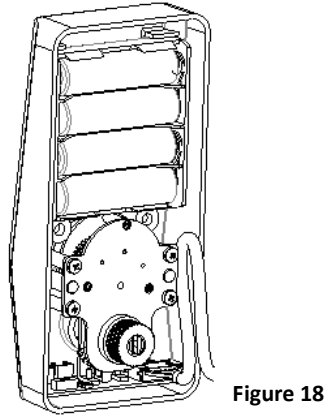

Figure 18

2. Tuck the connecting wire as shown in **Figure 18**.

3. Place the silica gel backing plate on the rear panel assembly, turn the lock button to make the hole slot vertical to the ground, and insert locking bar into the hole slot (see **Figure 19** below). In this case, when you turn the lock button, the latch-bolt can spring out or back automatically.

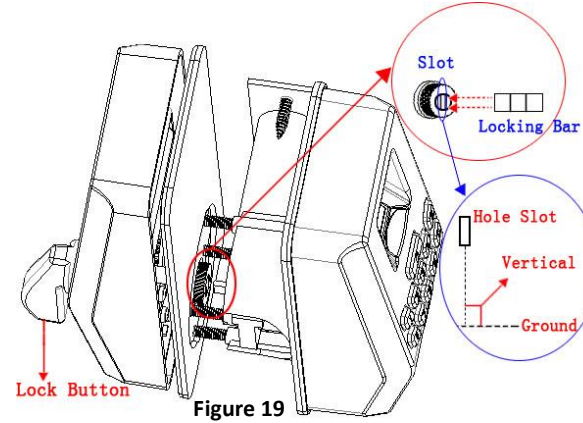

Figure 19

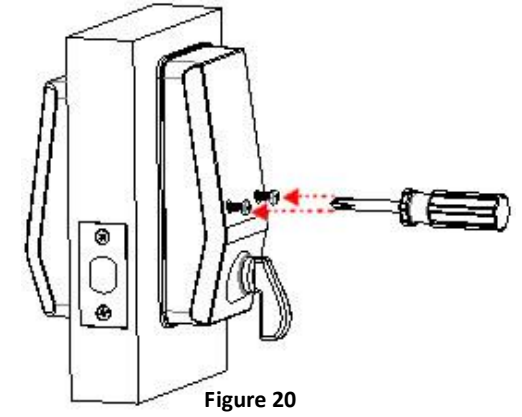
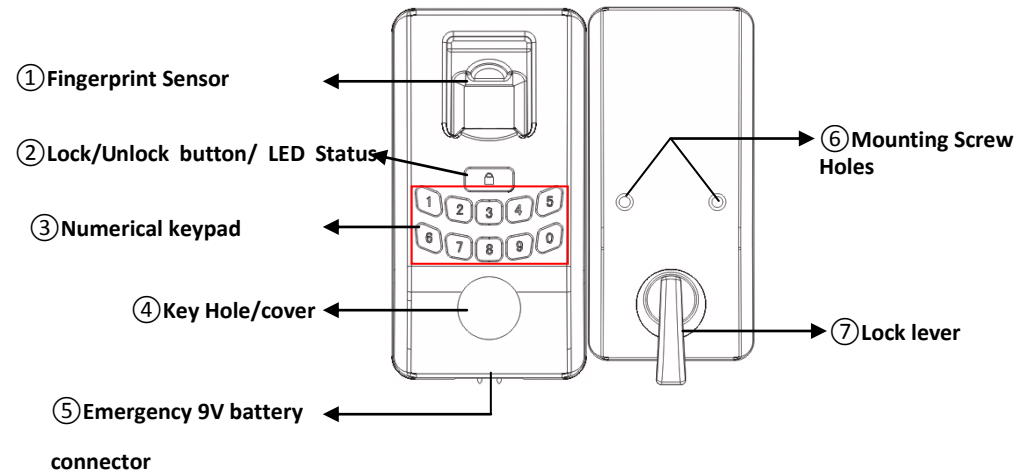

Figure 20

4. Place the rear panel assembly on the door to ensure that it can cover the whole back lining plate. Install screws and tighten them using a screwdriver as shown in **Figure 20**.

VII. Operating Instructions

1. Panel Description



2. Precautions

(1). After the deadbolt lock is installed, the deadbolt is in the “test state”, and therefore any fingerprints and PIN codes can open the deadbolt lock. Therefore, you must first change the Master Pass Code (MPC). The deadbolt can be used normally only after an “Administrator User” is enrolled. If the MPC is not changed, none of the functions in the deadbolt (except deadbolt initialization) are available. If no “Administrator User” is registered, “Ordinary Users” cannot be enrolled, either.



Note: For instructions on how to change the Master Pass Code, Enroll Administrator User or Enroll Ordinary User, please see **BL100 Fingerprint Deadbolt User Manual**.

(2). Do not remove batteries when matching, enrolling or deleting fingerprints because the sudden power-loss may result in data loss of fingerprint templates. Prior to removing batteries, make sure the deadbolt is not being operated.

(3). It is recommended to replace the deadbolt batteries at least once every six months to avoid damaging the deadbolt’s electronics due to the battery corrosion. Do not use poor-quality batteries.

3. LED Backlight Indicators

The LED Backlight Indicators contain three colors: Red, Green and Blue.

The general rule:

Successful user operation: The buzzer sounds once and the LED indicator will turn green for 3 seconds.

Failed user operation: The buzzer sounds short tone twice and the LED indicator turns red for 3 seconds.

Verify State: LED flashes Green.

Management Mode: Blue LED will turn on and green LED will turn off.

Warning Indication: The buzzer beeps five times intermittently.

4. Unlock with an Emergency Mechanical Key

You can open the door using an emergency mechanical key in case the electronic component does not operate.

- ① Use your fingernails or a hard chip to remove the lock cover.
- ② Insert the key into the keyhole and rotate 90° to unlock.

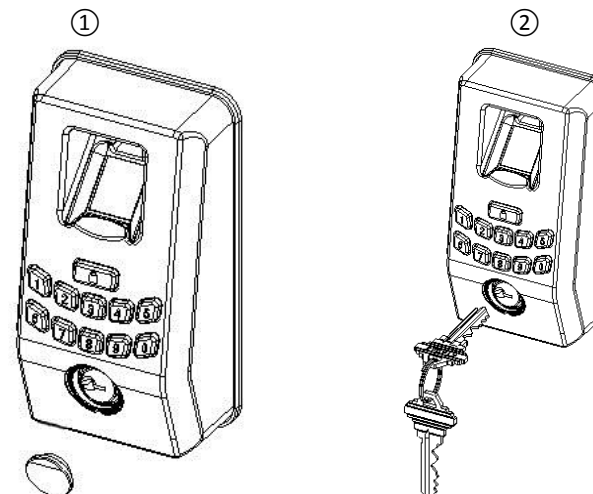

5. Battery Low Voltage Protection

When the AA batteries are running low, the deadbolt’s low-voltage alarm signals users to change the batteries as follows:

1. When the battery voltage reaches lower than 4.8V, the alarm buzzer will make a short sharp sound five times. Users can unlock the deadbolt normally but will not be able to enter the administrative user mode.
2. When the battery voltage reaches lower than 4.5V, the alarm buzzer will make a short sharp sound five times, and then the deadbolt will power off



Note: When the low-voltage alarm occurs, please change the batteries immediately to help prevent data loss (It is suggested to change the batteries immediately when the battery voltage is lower than 4.8V).

VIII. Routine Maintenance

1. The deadbolt's surface should not be exposed to corrosive substances. Otherwise, the protective layer of the deadbolt's surface may be damaged, and therefore the "glossiness" of the deadbolt surface may decrease. To keep the deadbolt surface glossy, use furniture polish (i.e. Pledge) wax to polish the deadbolt lock regularly.
2. Use a soft dry cloth to wipe built-up dirt on the fingerprint sensor after being used for a long time.
3. Change the batteries immediately when the low battery power alarm sounds. We recommend replacing the four old batteries with four new batteries of the same brand. Don't mix and match new and used batteries.
4. Regularly check whether screws are loose. Tighten screws when necessary.

